

Available  
**APRIL 1, 2019**

**488 sq. ft. Office Space for Lease**



## **4043 Carling Avenue – Suite LL12**

### **Property Features**

- Ample on-site parking
- Visitor's and handicap parking area
- Elevator in building
- Easy access to Queensway from March Road
- Free Form Fitness in lower level
- Common showers
- Main electrical – 600 V / 600 A / 3 phase

### **Suite Features**

- Contiguous with LL-6 (6,574 s.f. and LL-8 (1,825 sq. ft.) for a total of 8,887 sq. ft.
- Open office area
- Close to all amenities and public transit
- Will customize to suit



## Floor Plan

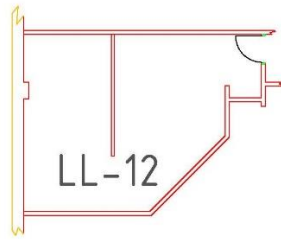

Suite LL-12: 488 SQ. FT.  
4043 Carling Avenue (Kanata)

Contiguous with LL-6: 6,574 sq. ft. and  
LL-8 (1,825 sq. ft.)  
Total available: 8,887 sq. ft.

